

WESTMEAD OFFICE COMPLEX

2119 Westmead Drive
Decatur, Alabama

MULTI-USE OFFICE SPACE



GATEWAY
COMMERCIAL BROKERAGE



For More Information, Please Contact:

Michael Nance
(256) 214-0531
Salesperson
michael@gatewaycommercial.net

GATEWAY COMMERCIAL BROKERAGE, INC.

300 Market Street, Suite 3
(256) 355-0721

Decatur, AL 35601

www.gatewaycommercial.com

Details contained, herein, are from sources we deem reliable. However, no liability is assumed for errors or omissions. This offering is subject to change or be withdrawn without notice. All tax, legal, or financial matters, herein, should be reviewed by competent professionals.

WESTMEAD OFFICE COMPLEX

2119 Westmead Drive SW, Suite 2

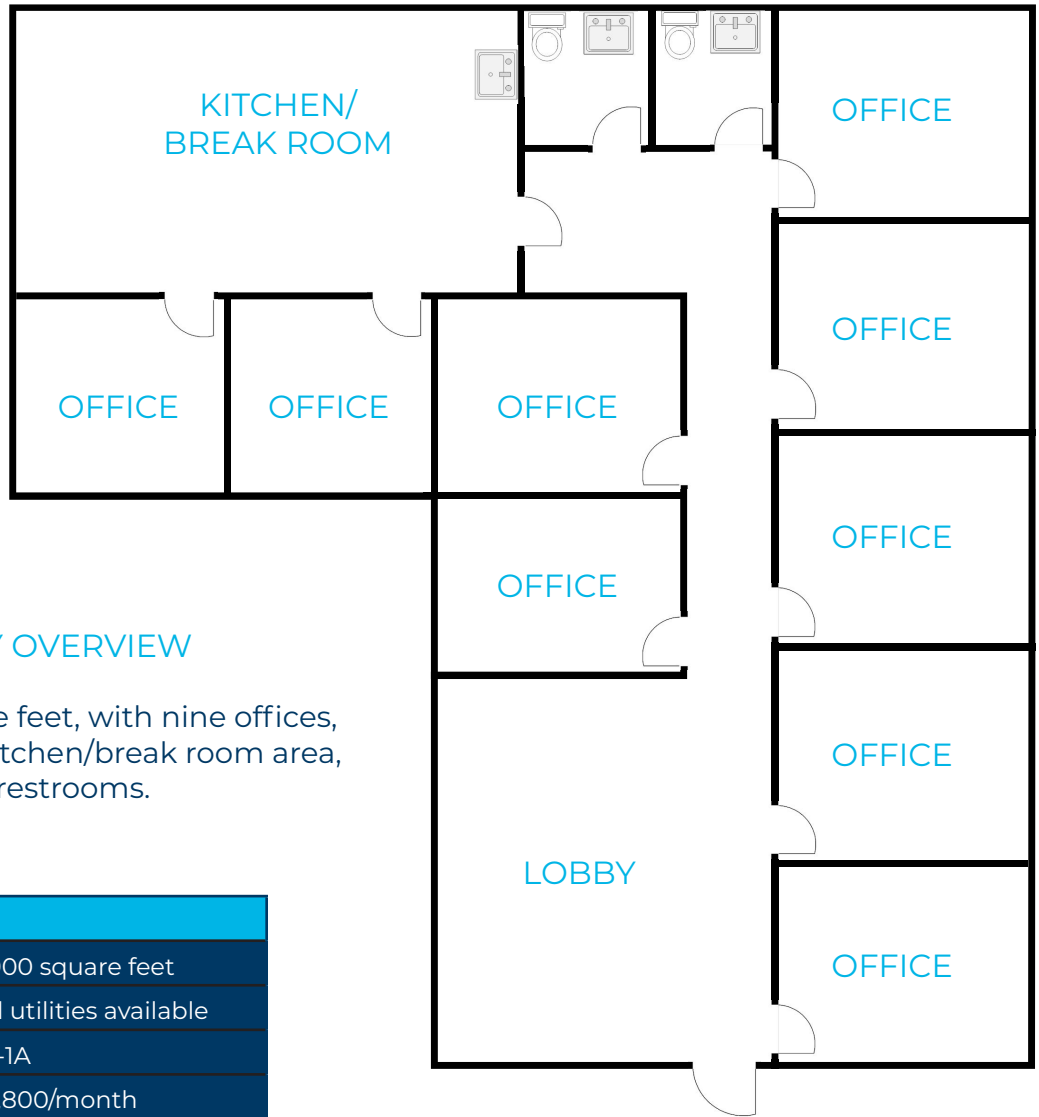

PROPERTY OVERVIEW

Suite 12 is 1,900 square feet, with nine offices, a front lobby area, a kitchen/break room area, and two restrooms.

SITE FEATURES	
SUITE SIZE	1,900 square feet
UTILITIES	All utilities available
ZONING	M-1A
LEASE PRICE	\$1,800/month

For More Information, Please Contact:

Michael Nance
(256) 214-0531
Salesperson
michael@gatewaycommercial.net

GATEWAY COMMERCIAL BROKERAGE, INC.
300 Market Street, Suite 3
(256) 355-0721
Decatur, AL 35601
www.gatewaycommercial.com

Details contained, herein, are from sources we deem reliable. However, no liability is assumed for errors or omissions. This offering is subject to change or be withdrawn without notice. All tax, legal, or financial matters, herein, should be reviewed by competent professionals.