

GATEWAY SHOPPING CENTER Decatur, Alabama

Office/Retail Space



GATEWAY

COMMERCIAL BROKERAGE



PROPERTY OVERVIEW

Gateway Shopping Center is located on 6th Avenue in Decatur, Alabama. This commercial corridor is the heart of the southeast retail district. This property offers 156,515 square feet of prime retail space. Anchored by Big Lots and Hometown Market, this shopping center offers an excellent tenant mix for any retail establishment.

For More Information, Please Contact:

Emmette Barran, CCIM

(256) 303-1703

Qualifying Broker

ebarran@gatewaycommercial.net

George A. Barran

(256) 303-1109

Broker

gbarran@gatewaycommercial.net

GATEWAY COMMERCIAL BROKERAGE, INC.

300 Market Street, Suite 3

(256) 355-0721

Decatur, AL 35601

www.gatewaycommercial.com

Details contained, herein, are from sources we deem reliable. However, no liability is assumed for errors or omissions. This offering is subject to change or be withdrawn without notice. All tax, legal, or financial matters, herein, should be reviewed by competent professionals.

GATEWAY SHOPPING CENTER

Office/Retail Space

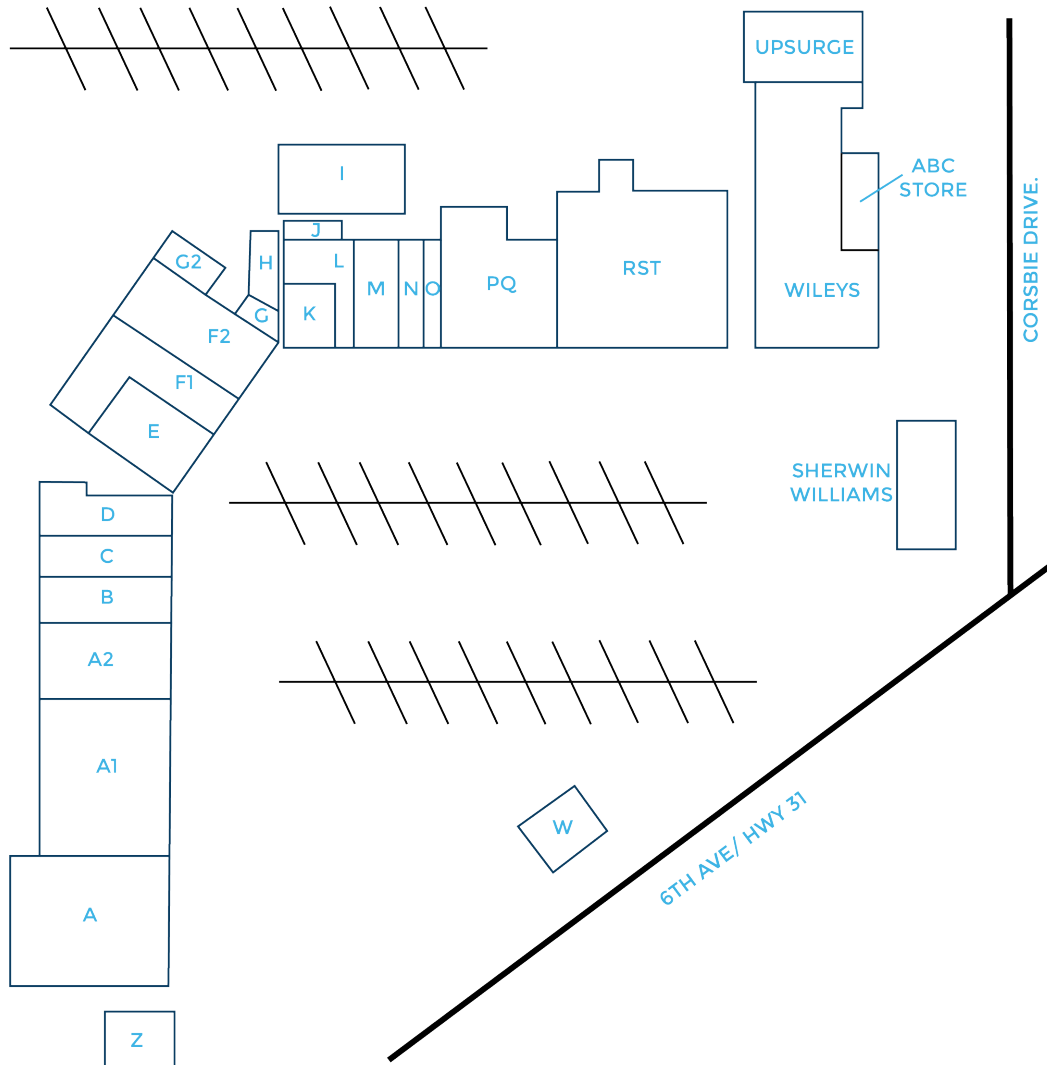

A	Big Lots	21,120 square feet	I	Vacant Theater	11,250 square feet
A1	Big Lots Furniture	14,500 square feet	J	Owner Storage	2,000 square feet
A2	Better Than Before	8,500 square feet	K	Gloria's Good Health	4,715 square feet
B	Check N Go	2,000 square feet	L	Gloria's Good Health	1,250 square feet
C	Downtown Dawgs	2,500 square feet	M	China Buffet	3,300 square feet
D	Sally Beauty Supply	3,100 square feet	N	Boost Mobile	2,500 square feet
E	Rent-A-Center	8,640 square feet	O	Stitchez	2,500 square feet
F1	Valley Computers	6,600 square feet	PQ	It's Fashion Metro	10,500 square feet
F2	Family Dollar Store	8,370 square feet	RST	Hometown Market	33,200 square feet
G	Releve	1,800 square feet	W	Domino's Pizza	2,500 square feet
G-2	Stairways Group	2,070 square feet	Z	AVAILABLE	2,400 square feet
H	Miracle's Beauty Salon	1,200 square feet			

GATEWAY SHOPPING CENTER

Office/Retail Space

GATEWAY SHOPPING CENTER AND NATIONAL RETAILERS

